

# **CHARLOTTE BUILDING**

**—  
A DYNAMIC W1 LOCATION  
IN A RARE POCKET OF CALM.**

**CHARLOTTE BUILDING  
17 GRESSE STREET W1**

**—  
5,958 SQ FT OF STUNNING,  
OPEN PLAN OFFICE SPACE  
FEATURING A PRIVATE TERRACE,  
ON THE TOP FLOOR OF THIS  
AWARD-WINNING DEVELOPMENT.**





Charlotte Building, 17 Gresse Street

## KEY FEATURES

- FULLY REFURBISHED SIXTH FLOOR PROVIDING 5,958 SQ FT OF BRIGHT, OPEN PLAN OFFICE SPACE
- 732 SQ FT LANDSCAPED TERRACE OFFERING PANORAMIC VIEWS OF LONDON
- 3.1M FLOOR TO CEILING HEIGHT
- NEW RAISED FULLY ACCESSIBLE METAL TILED FLOOR
- SUPERB NATURAL LIGHT
- DISPLACEMENT AIR CONDITIONING SYSTEM
- LOW ENERGY, INTELLIGENT LIGHTING SYSTEM WITH CIRCULAR FEATURE FITTINGS
- LANDSCAPED COURTYARD
- BRIGHT AND CONTEMPORARY RECEPTION AREA
- THREE PASSENGER LIFTS AND ONE GOODS LIFT
- THREE UNISEX SUPERLOOS AND ONE FULLY ACCESSIBLE WC
- BICYCLE STORE AND FULLY ACCESSIBLE SHOWERS
- ACCESS TO RATHBONE PLACE FROM GRESSE STREET



Reception featuring bespoke circular light fittings

# AVAILABILITY

—

## SCHEDULE OF AREAS:

FLOOR	SQ FT	SQ M
SIXTH	5,958*	553*

\*Excludes external terrace

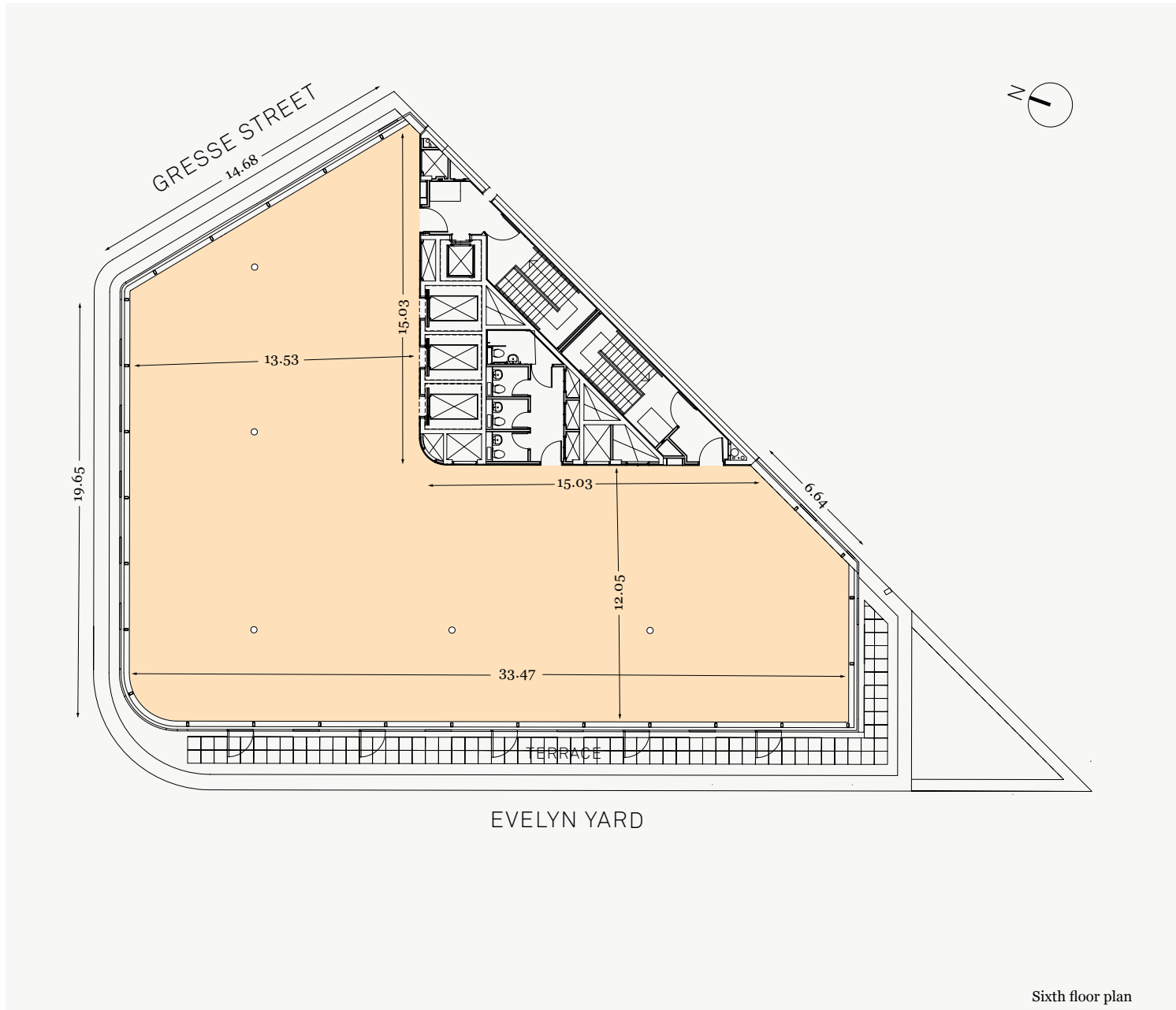





Sixth floor penthouse office



Charlotte Building, Evelyn Yard



Reception featuring bespoke circular lighting



Sixth floor terrace



Sixth floor penthouse office

# LOCATION

## OCCUPIERS

01. 1 Stephen Street  
AnaCap  
BrandOpus, Encompass  
Digital Media, Fremantle and  
Freud Communications
02. 2 Stephen Street  
Fremantle  
The Office Group
03. 20th Century Fox Film Co
04. 9 & 10 Rathbone Place  
Made Thought, Zest Design &  
Marketing and Londonewcastle
05. The Arcadia Group
06. Arup Associates
07. Betgenius
08. British Film Institute
09. Charlotte Building  
The BIO Agency, Converse and  
CHI & Partners
10. Dolby Europe
11. Double Negative Visual Effects
12. The Engine Group
13. Estee Lauder
14. The Fashion Retail Academy
15. Gardiner & Theobald
16. Google London
17. Holden House  
Envy Post Production and  
Cubo Communications
18. Lionsgate Film
19. Make Architects
20. NBC Universal
21. Nike
22. Qube  
Hok International and EDF Energy
23. Specific Media
24. Sony DADC UK
25. Universal Pictures

## RESTAURANTS

01. Aqua London
02. Bubbledogs
03. Dabbous
04. Ceviche
05. Crazy Bear
06. Dehesa
07. Fernandez & Wells
08. Gaucho
09. Hakkasan
10. Lima
11. Pied A Terre
12. Polpo
13. Riding House Cafe
14. Roka
15. Rum Kitchen
16. Salt Yard
17. Social Eating House
18. Stephen Street Kitchen

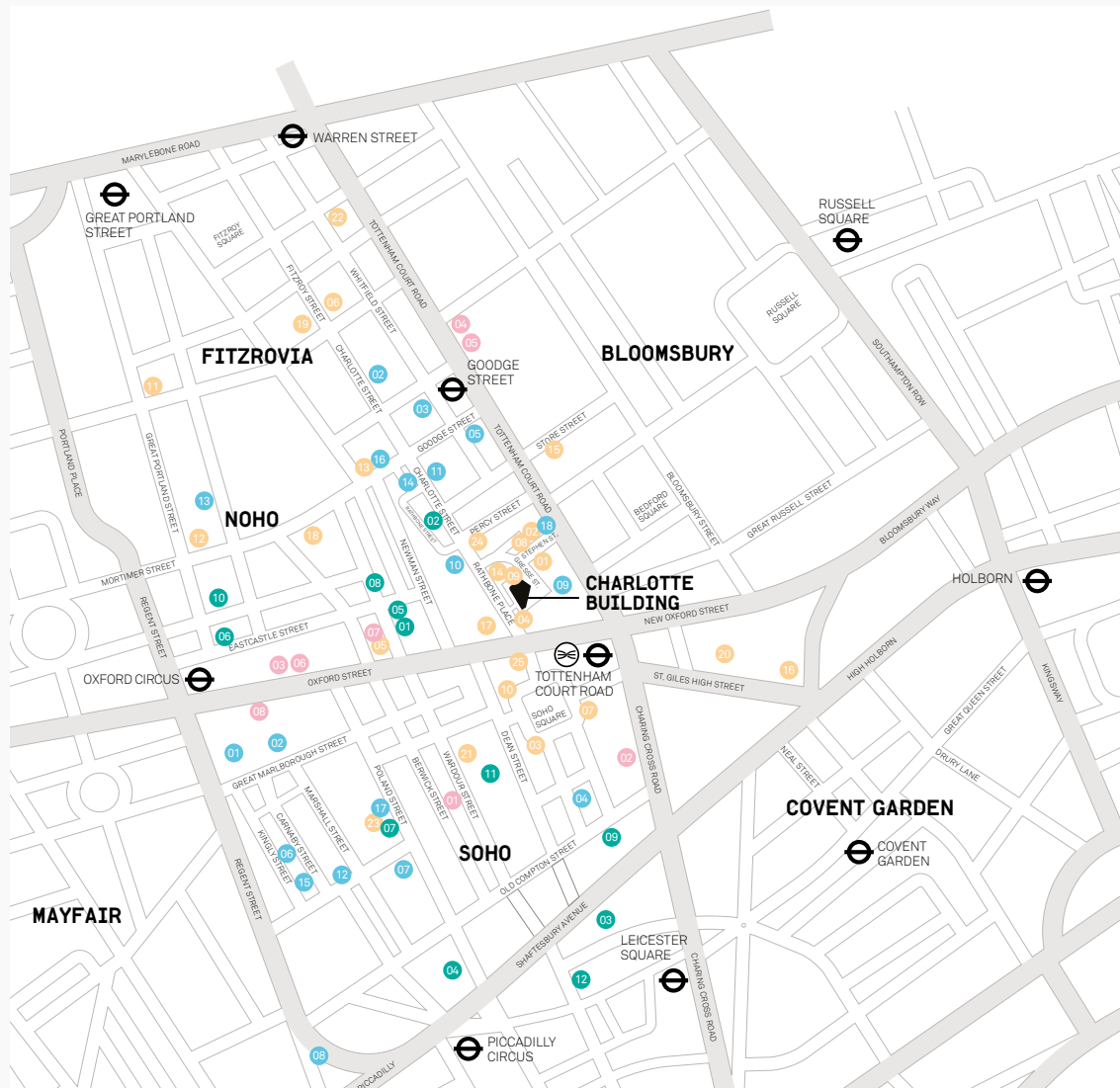

## RETAIL

01. Agent Provocateur
02. Foyles Bookshop
03. H&M
04. Habitat
05. Heals
06. Uniqlo
07. Waterstones
08. Zara

## BARS + HOTELS

01. Berners Tavern
02. Charlotte Street Hotel
03. Experimental Cocktail Club
04. Ham Yard Hotel
05. The London Edition
06. Market Place
07. Milk & Honey
08. Sanderson Hotel
09. Soho House
10. The Social
11. The Soho Hotel
12. W Hotel



# SURROUNDINGS



Dean Street Townhouse, Dean Street



Charlotte Street, W1



Drakes Tabanco, Windmill Street



Crazy Bear Fitzrovia, Whitfield Street



Charlotte Street Hotel, Charlotte Street



Social Eating House, Poland Street



Lima, Rathbone Place



Dabbous, Whitfield Street

## TEAM

---

---

### ARCHITECT

Lifschutz Davidson Sandilands

---

### AGENTS

HMC 020 7439 1500

Peter Hutchinson

020 7297 9665

[P.Hutchinson@hmc.gb.com](mailto:P.Hutchinson@hmc.gb.com)

Graham Rossall

020 7297 9663

[G.Rossall@hmc.gb.com](mailto:G.Rossall@hmc.gb.com)

Ashwell Rogers 020 7734 7766

Ash Sharma

020 7758 3285

[Ash@ashwellrogers.com](mailto:Ash@ashwellrogers.com)

Tom Owtram

020 7758 3287

[Tom@ashwellrogers.com](mailto:Tom@ashwellrogers.com)

---

### ENERGY PERFORMANCE CERTIFICATE (EPC)

Rating: B

---

### WEBSITE

[charlottebuildingw1.com](http://charlottebuildingw1.com)

---

### PHOTOGRAPHERS

Matt Chisnall

Nick Rochowski

---

### MISREPRESENTATION ACT

Whilst every effort has been made to ensure accuracy, no responsibility is taken for any error, omission or mis-statement in these particulars which do not constitute an offer or contract. No representation or warranty whatever is made or given either during negotiations or in particular by the vendor, lessors or agents Messrs Ashwell Rogers and HMC. All figures are exclusive of rates, service charge, VAT and all other outgoings. The agents have not tested the services. All floor areas are approximate. Date of preparation June 2015



## DERWENT LONDON

---

Derwent London plc owns a 5.7m sq ft portfolio of commercial real estate which is predominantly located in central London, making it the largest London focused real estate investment trust (REIT).

Our experienced team has a long track record of creating value throughout the property cycle by regenerating our buildings via development or refurbishment, effective asset management and capital recycling.

Fitzrovia is an important element of our portfolio and comprises 1.6m sq ft in over 35 properties. We are committed to supporting the local community and since 2013 we have enabled the delivery of many worthwhile projects through our Fitzrovia Community Fund.

---

### OTHER DERWENT LONDON PROPERTIES

#### 80 CHARLOTTE STREET W1

Size: 380,000 sq ft

Architects: Make

Completion: 2018



#### DAVIDSON BUILDING WC2

5 Southampton Street

Size: 41,700 sq ft

Architects: Lifschutz Davidson Sandilands

Completion: 2003



#### 1+2 STEPHEN STREET W1

Size: 266,500 sq ft

Architects: Orms

Completion: 2013-2015



#### ONE OXFORD STREET W1

Size: 275,000 sq ft

Architects: AHMM

Completion: 2020



DERWENT  
LONDON

derwentlondon.com